

# LINE CLAMPING SYSTEMS

HYDRAULICS

## Walker-Strut® Clamp

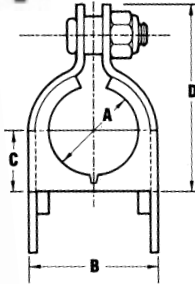

UNISTRUT  
CHANNEL FOR  
LINE CLAMPS

### GENERAL INFORMATION

The new controlled squeeze shoulder stud practically eliminates the possibility of overtightening, resulting in uniform clamp pressure. Vibration and shock is dispersed uniformly throughout the system due to the equal clamp pressure.

### APPLICATION

Used to reduce vibration, noise, and shock in fluid systems. Installation is easy: Mount the base channel, position the clamp, and tighten!

TUBE CLAMP ASSEMBLIES							ORDER INFORMATION	
COPPER AND STEEL TUBING	COPPER WATER PIPE (NOM)	A	B	C	D	REFERENCE	STOCK NUMBER	PRICE
1/4"		.25	.62	.27	.98	WS-04	GS00140	1.74
3/8"	1/4"	.37	.82	.33	1.13	WS-06	GS00141	1.66
1/2"	3/8"	.50	.94	.40	1.34	WS-08	GS00142	1.66
5/8"	1/2"	.62	1.06	.46	1.54	WS-10	GS00143	1.68
3/4"	5/8"	.75	1.20	.52	1.68	WS-12	GS00144	1.90
1-1/8"	1"	1.12	1.57	.70	2.08	WS-18	GS00148	2.56
1-1/4"		1.25	1.70	.77	2.21	WS-20	GS00147	2.76
1-1/2"		1.50	1.95	.90	2.60	WS-24	GS00149	3.30

PIPE CLAMP ASSEMBLIES						ORDER INFORMATION	
NOMINAL PIPE SIZE	A	B	C	D	REFERENCE	STOCK NUMBER	PRICE
3/8"	.67	1.13	.49	1.54	WS-06P	GS00101	2.22
1/2"	.84	1.29	.58	1.82	WS-08P	GS00102	2.44
3/4"	1.05	1.50	.70	1.95	WS-12P	GS00103	2.68
1"	1.31	1.76	.81	2.34	WS-16P	GS00104	3.06
1-1/4"	1.66	2.17	.99	2.73	WS-20P	GS00105	4.04
1-1/2"	1.90	2.35	1.09	2.86	WS-24P	GS00106	5.32

UNISTRUT CHANNEL		ORDER INFORMATION	
TYPE	DIMENSION	STOCK NUMBER	PRICE
STEEL SINGLE ANCHOR CHANNEL (GREEN)	16 ga. x 13/16" x 1-5/8"	GS00200	4.60

# CLAMPING SYSTEMS

HYDRAULICS



## Econo-Isolator Clamping System

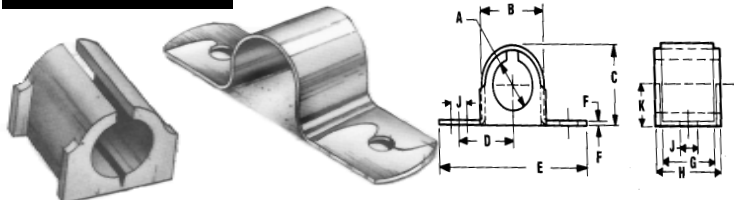

### GENERAL INFORMATION

The clamp is a low cost, easy, way to attach tubing and hose to equipment without the use of special channels. Just bolt the clamp directly to machine frame or structural frame.

### APPLICATION

Used to reduce vibration, shock and noise in fluid systems.

CLAMPING											ORDER INFORMATION		
COPPER AND STEEL TUBING O.D.	A	B	C	D	E	F	G	H	J	K	REFERENCE	STOCK NUMBER	PRICE
3/8"	.37	.62	.62	.65	1.90	.06	.62	.81	.20	.31	HC-OC-06	GS99900	1.38 <small>WHILE SUPPLIES LAST</small>
1/2"	.50	.82	.75	.80	2.20	.06	.75	.98	.26	.38	HC-OC-08	GS00207	1.38 <small>WHILE SUPPLIES LAST</small>

GRAND RAPIDS

TOLL FREE 1-800-968-0188  
PHONE: (616) 949-8844  
FAX: (616) 949-6598

KALKASKA

TOLL FREE 1-800-355-4338  
PHONE: (616) 258-4338  
FAX: (616) 258-2696